

CRÓQUI DE LOCALIZAÇÃO DE JAZIDA E BOTA-FORA SEM ESCALA

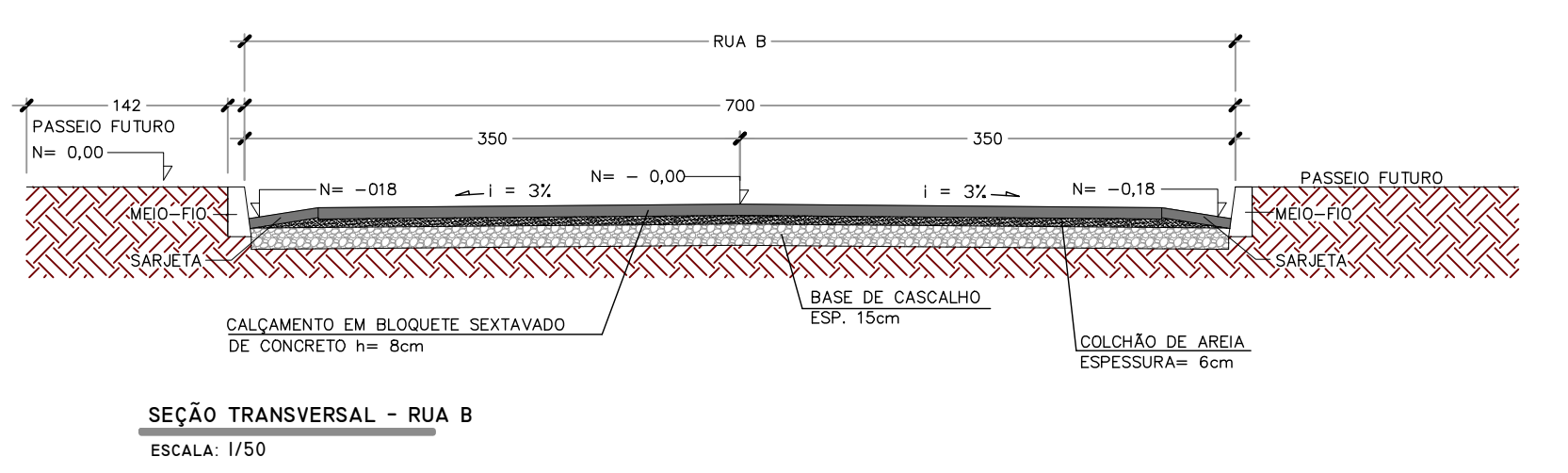
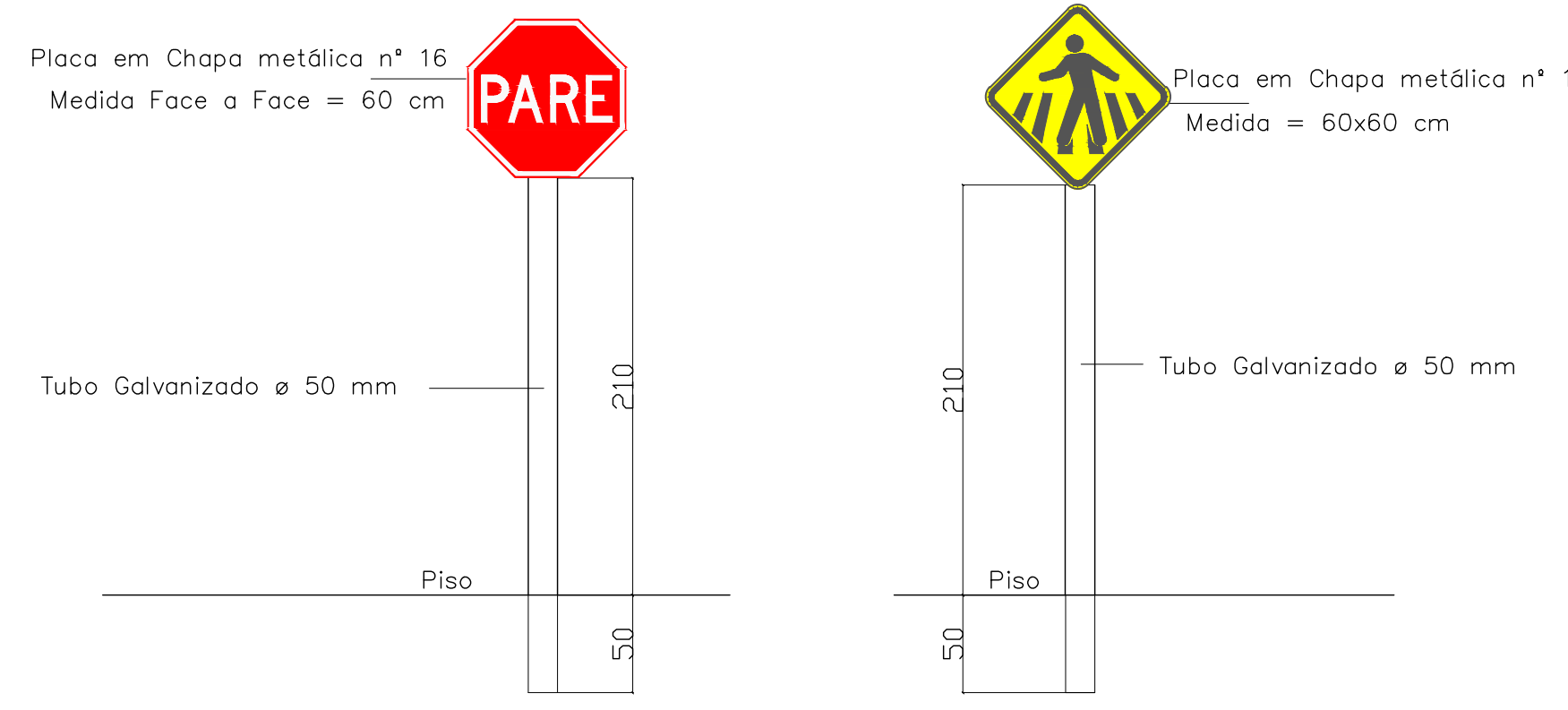
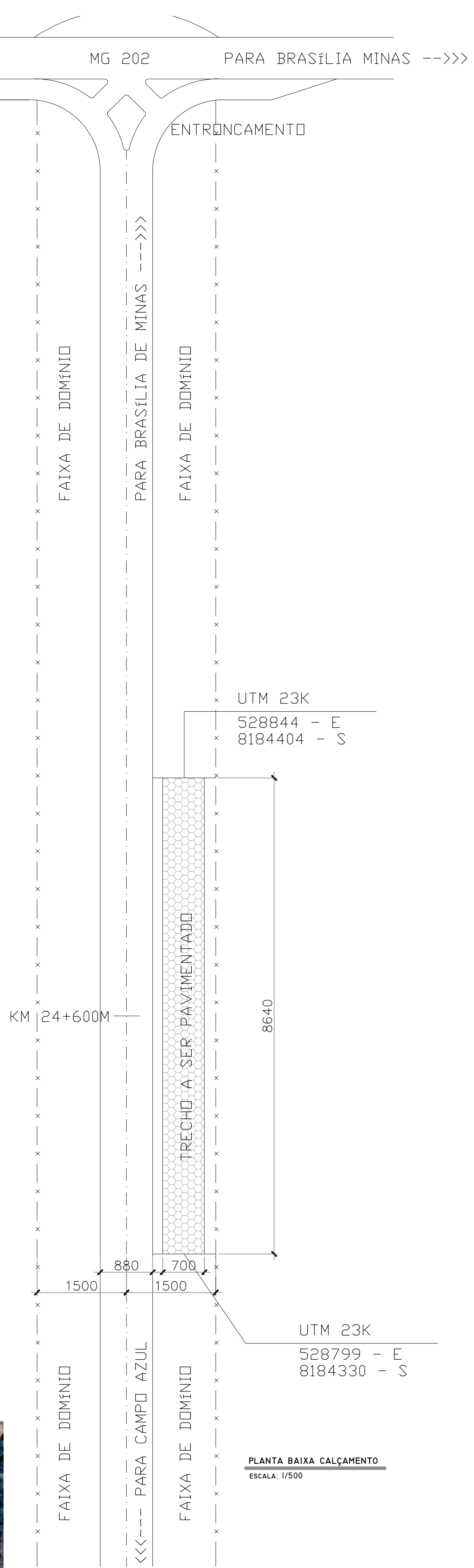
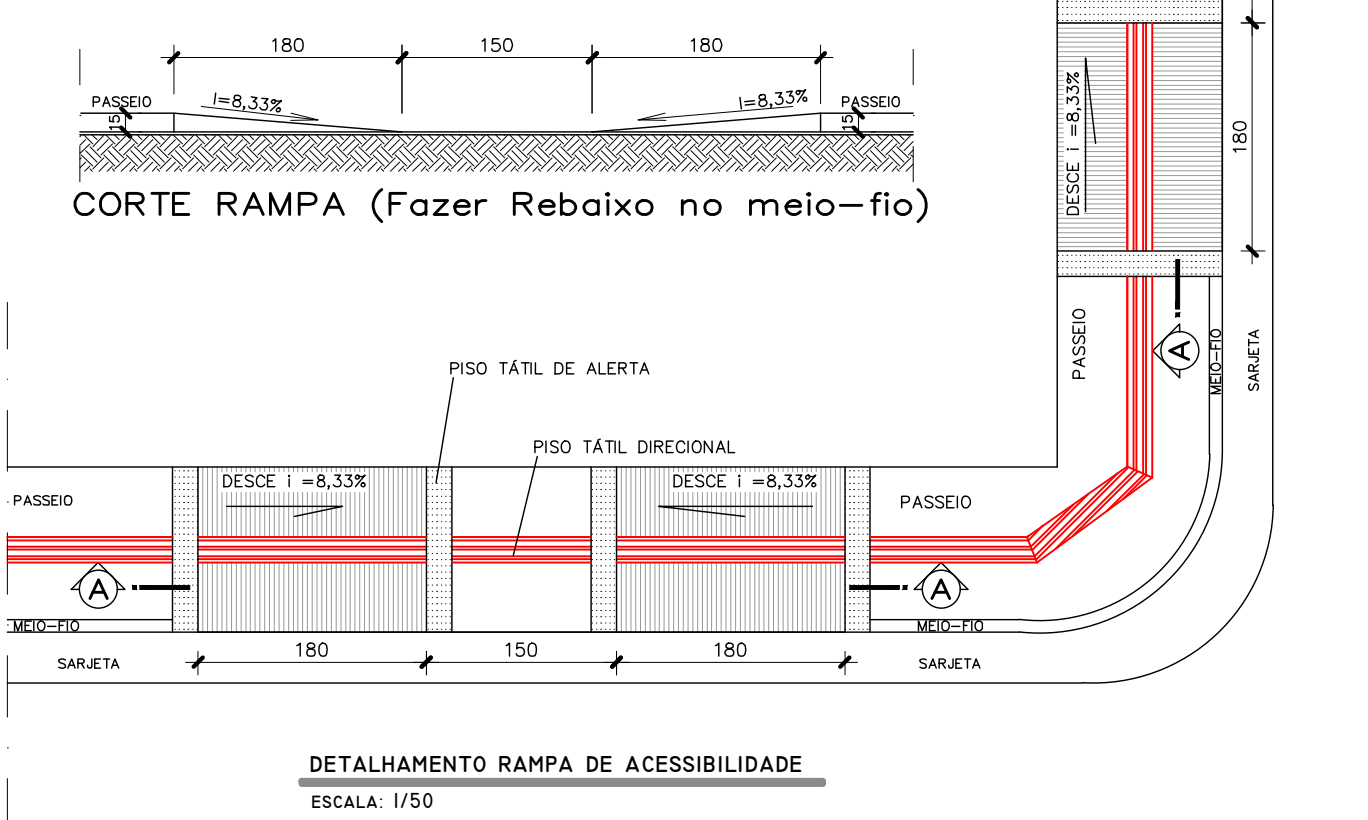
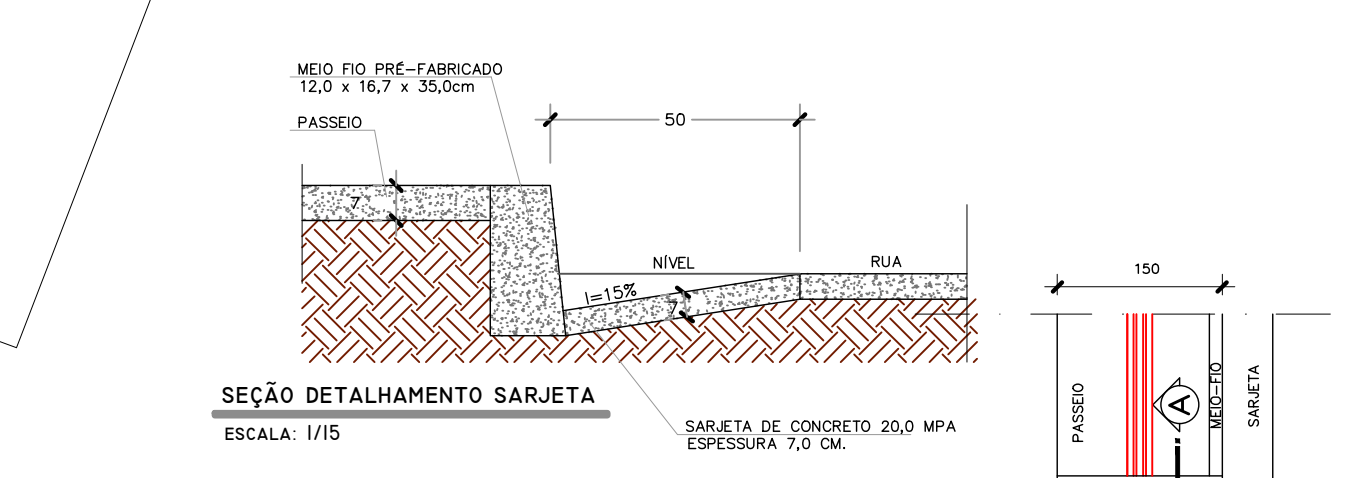
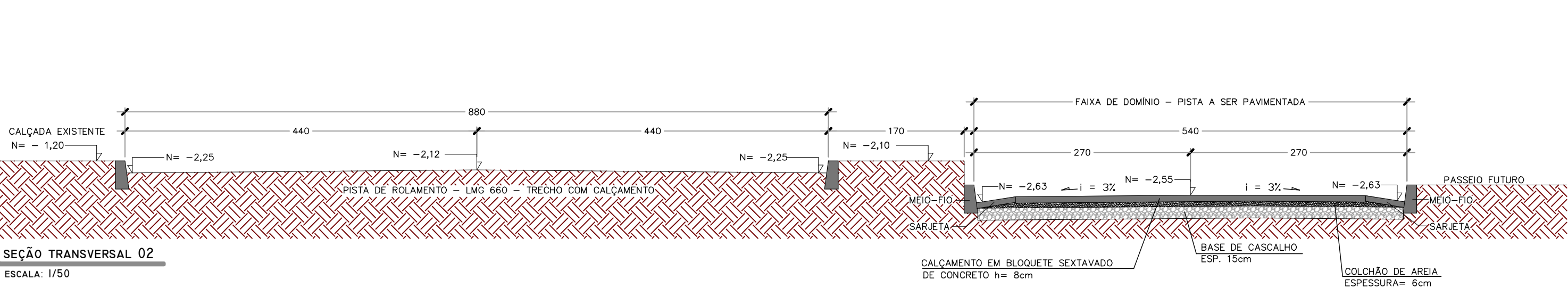
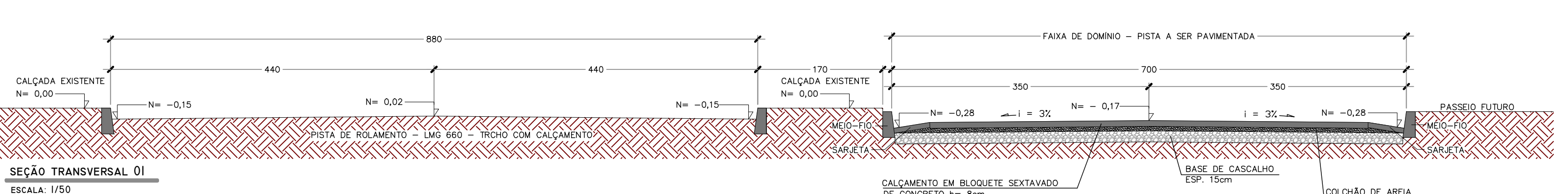
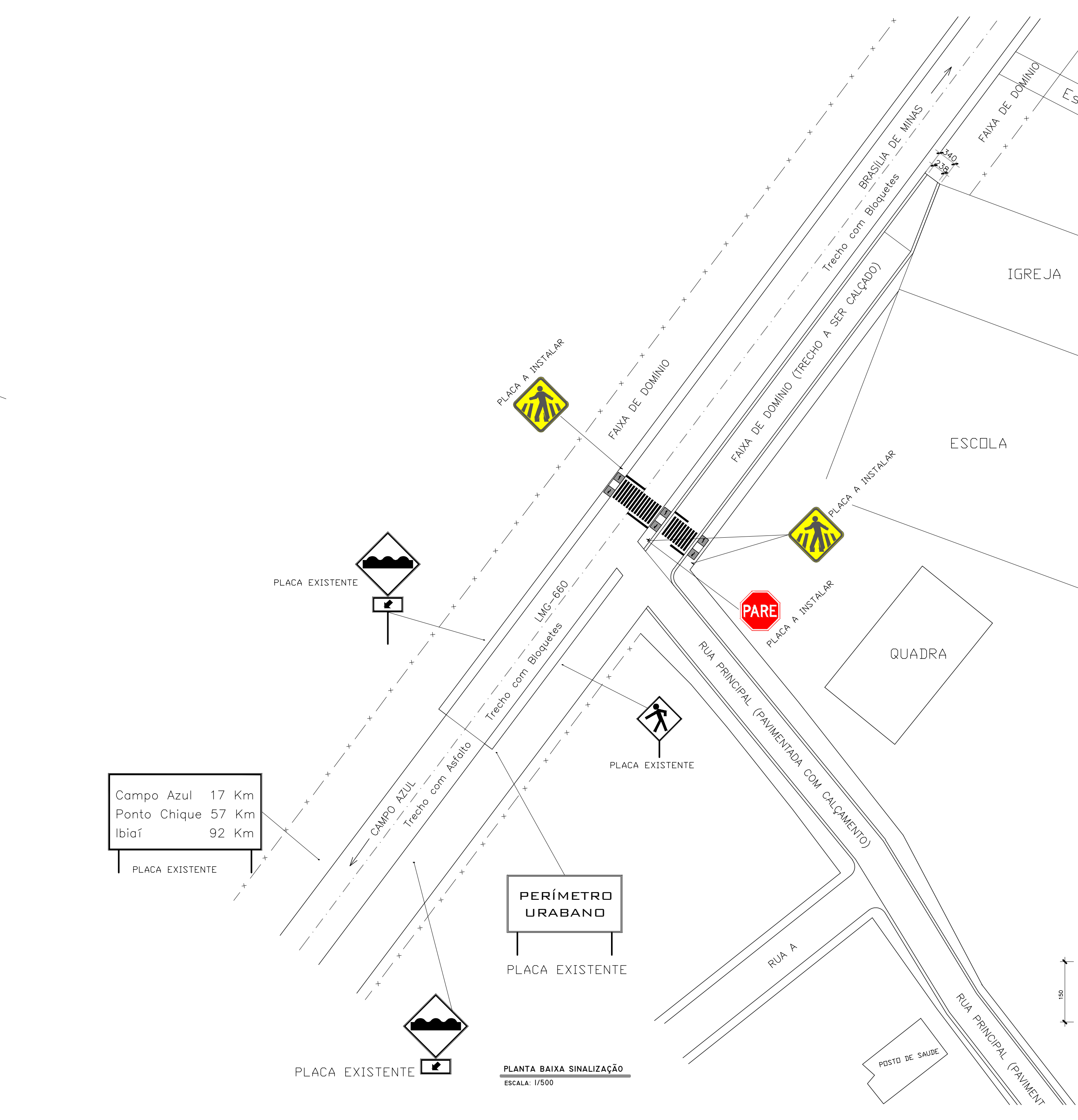
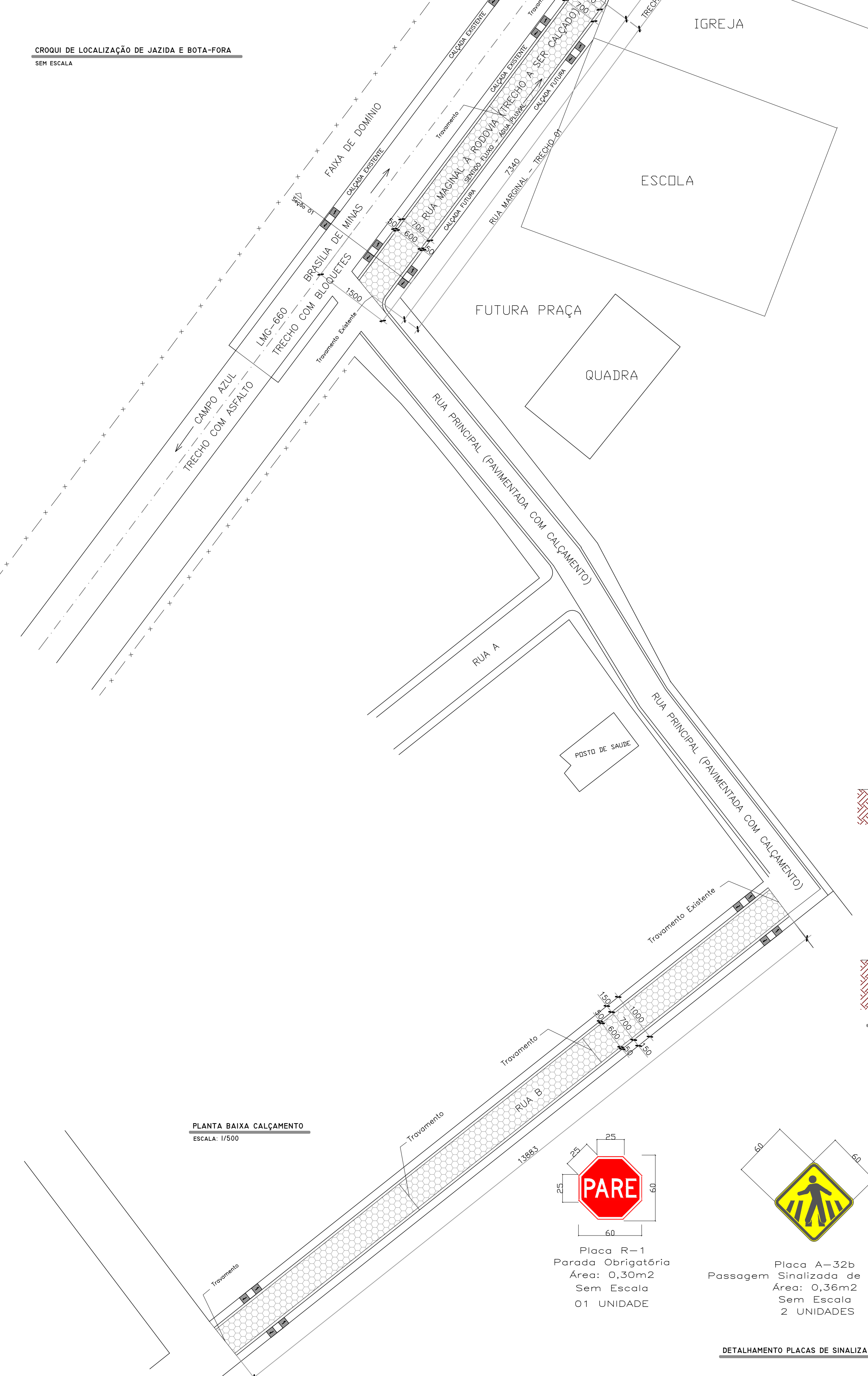

PREFEITURA MUNICIPAL DE CAMPO AZUL/MG	
PAVIMENTAÇÃO EM VIAS URBANAS	
PROPRIETÁRIO: PREFEITURA MUNICIPAL DE CAMPO AZUL/MG CNPJ: 01.612.551/0001-79	
ENGENHEIRO: OSEAS ALMEIDA JÚNIOR CREA: MG-224-816/0	
PROJETO: CALÇAMENTO COM BLOCOS SEXTAVADOS DE CONCRETO	
RESPONSÁVEL TÉCNICO: MARCOS PAULO MADUREIRA LOPES CREA: MG-224-816/0	
ÁREAS:	ART. Nº: MG20210712804
ÁREA TOTAL DE INTERVENÇÃO: 1.553,21m ²	PROPOSTA Nº:
ÁREA DE CALÇAMENTO: 1.327,98m ²	
EXTENSÃO DE MEIO-FIO: 482,86m	
EXTENSÃO DE SARJETA: 450,46m	
DATA: NOVEMBRO/2021	ESCALA: INDICADA